

# SMARTSHAFT™

CROSS-LAMINATED TIMBER (CLT)  
STAIRWELL & ELEVATOR SHAFTS



**SMARTLAM**™  
| NORTH AMERICA |



**POPLAR OFFICE BUILDING**  
Photos courtesy of Lara Swimmer  
Photography (also cover image)

Our mission at **SMARTLAM** is to bring speed and efficiency to commercial construction. We accomplish this by compressing construction time and reducing cost, as well as risk.

In 2016, we created the first Cross-Laminated Timber (CLT) elevator shaft in the US. We passed the ASTM E119 fire test with a 2hr FRR for specific grades and have become the leader in CLT stairwells and elevator shafts.

Our SmartShaft is simple to integrate into conventionally framed buildings, and our customers achieve dramatic reductions in construction cycle times. You do not have to be constructing a mass timber structure to benefit from the amazing time saving you get from a **SMARTLAM SMARTSHAFT**.

CLT is the sustainable building solution - sequestering carbon in every cubic foot. Proudly manufactured in the USA, we procure our lumber from regional sawmills that follow certified, sustainable forestry practices - in fact, all of our lumber is SFI certified.

Additionally, our CLT is federally certified as a Bio-Preferred product with the USDA. We manufactured the first Bio-Preferred CLT in the United States for a USDA Forest Service Supervisor's Office, including an elevator shaft.

*SmartLam's CLT shafts are "massive time and money savers."*

**Drew Wing, COO Zachau Construction**

***sales@smartlam.com***  
**smartlam.com | 406.892.2241**

## CROSS-LAMINATED TIMBER (CLT) VS CONCRETE MASONRY UNITS (CMU)

C  
L  
T



Hours	<b>INSTALLATION</b>	3-4 weeks
One	<b>TRADES</b>	Multiple
One	<b>INSPECTIONS</b>	Multiple
Panelized Design	<b>COMPONENTS</b>	Thousands
Minimal	<b>POTENTIAL WEATHER IMPACT</b>	Significant

C  
M  
U



# SMARTLY BENEFICIAL



Reduces construction time resulting in financial benefits for contractors & owners

---



Simple, panelized design reduces the number of pieces to install

---



Meets or exceeds fire and acoustic code requirements

---



Precision CNC cut panels reduces labor and exposure to risk

---



Straight, square, and dimensionally stable ensures proper fit every time

---



Improved jobsite noise

---



Fewer inspections required during and after installation

**POPLAR OFFICE BUILDING**

Photos courtesy of Lara Swimmer  
Photography (also cover image)

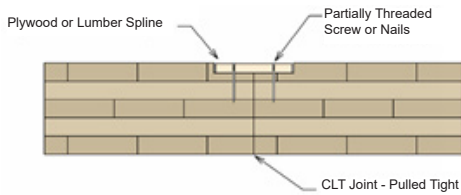

**ROOF PANEL TO PANEL  
PLYWOOD SPLINE**

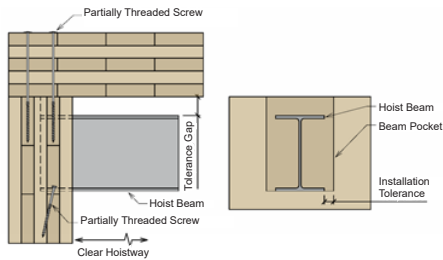

**ELEVATOR HOIST  
BEAM POCKET**

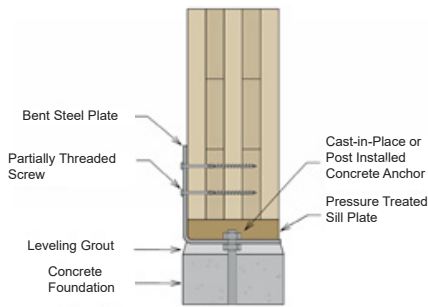

**CLT WALL BASE  
CONNECTION**

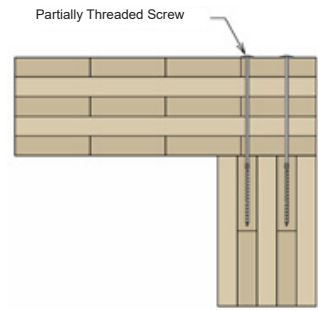

**CLT ROOF TO CLT WALL**

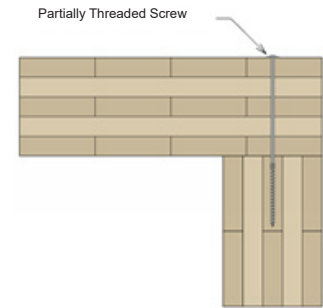

**CLT WALL TO WALL**

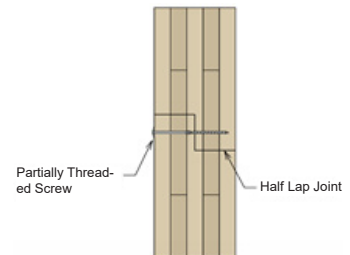

**VERTICAL CLT WALL  
PANEL SPLICE**

## SERVICES AND SOLUTIONS

### ENGINEERING AND DESIGN

Our engineering and design team provides services during all phases of a project including conceptual design, schematic design, design development, construction document creation, deferred submittals, shop/fabrication drawing creation, and construction support services. We are equipped with the tools and expertise to optimize engineering, detailing, and the fabrication process.

### CONSULTING

Our team of experts can assist you through every step of the project including code interpretation, assembly options, engineering services, drafting services, logistics, and more. We are solution driven and committed to satisfying your project requirements.

### VALUE ADDED SERVICES

At SmartLam, we are dedicated to the success of the project. Navigating the challenges associated with large scale construction and developing practical solutions is what we do. To facilitate successful completion of a project, we encourage an environment of communication with the design team and installers through pre-construction meetings. Additionally, our experience allows us to provide recommendations for rigging/lifting, and temporary shoring/bracing among other installation means and methods.

# SMARTLY INSTALLED

1

**BASE PLATES**



2

**SEQUENCED DELIVERY**



3

**HOIST WITH CRANE**

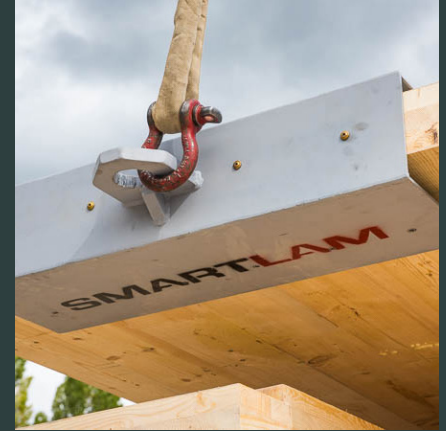

4

**FLY INTO PLACE**



5

**BRACE PANELS**



6

**SCREW TO SECURE**



# MANUFACTURING DIVISION LOCATIONS



**MONTANA FACILITY**  
**COLUMBIA FALLS**



**ALABAMA FACILITY**  
**DOTHAN**

## **ANSI/APA PRG 320** PRODUCT CERTIFICATIONS

SPF – V2M5 • SPF-S – V4M1 • DF/L – V1M2  
HF/WF – V5M1, V5M2

SYP – V3

---

If you have any further questions please feel free to reach out.  
We will provide you the information you need to get started.

***sales@smartlam.com***  
**smartlam.com | 406.892.2241**

---

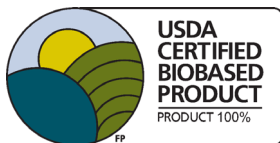

Our CLT is a Bio-Preferred Product through the USDA. This program includes voluntary labeling for federal contractors and agencies.

